

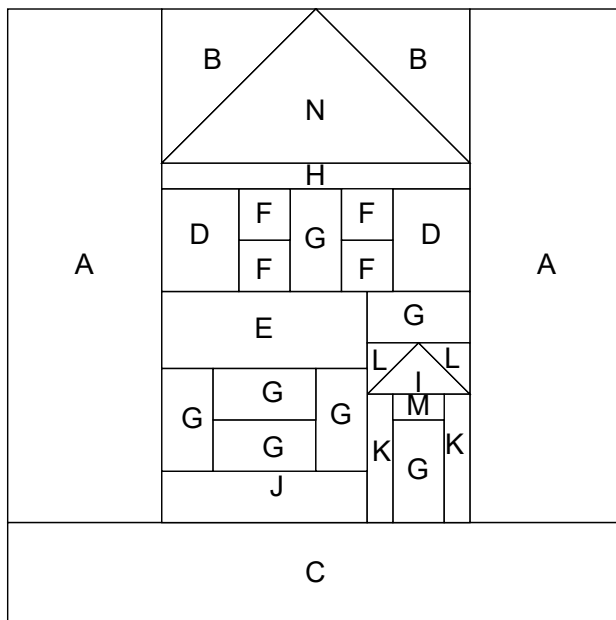

# MODA BAKE SHOP

- 1
- 2
- 3
- 4
- 5
- 6
- 7

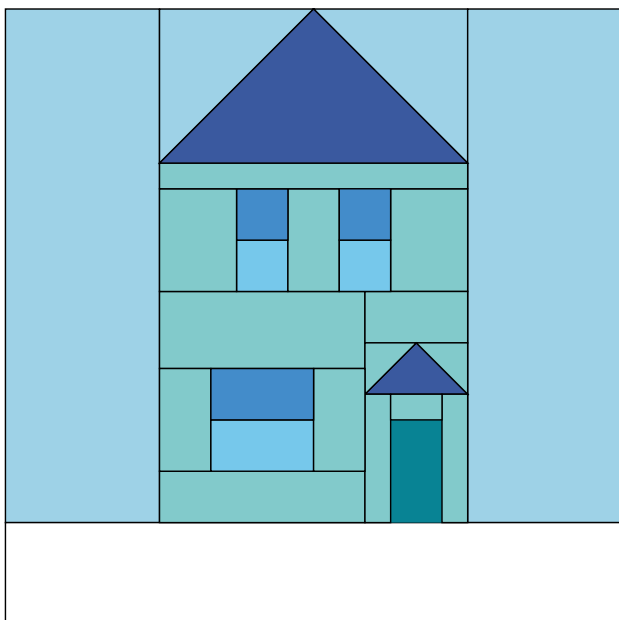

## TRADITIONAL PIECING

### Winter Chalet

## WINTER FROST



COUNTDOWN TO CHRISTMAS  
2020

### DESIGNED BY:

Carole Carter  
From My Carolina Home

## INGREDIENTS

### FROM FABRIC 1, CUT:

- {A} (2) 3½" x 10½" rectangles
- {B} (2) 3½" squares

### FROM FABRIC 2, CUT:

- {C} (1) 2½" x 12½" rectangle

### FROM FABRIC 3, CUT:

- {D} (2) 2" x 2½" rectangles
- {E} (1) 2" x 4½" rectangle
- {G} (4) 1½" x 2½" rectangles
- {H} (1) 1" x 6½" rectangle
- {J} (1) 1½" x 4½" rectangle
- {K} (2) 1" x 3" rectangles
- {L} (2) 1½" squares
- {M} (1) 1" x 1½" rectangle

### FROM FABRIC 4, CUT:

- {I} (1) 1½" x 2½" rectangle
- {N} (1) 3½" x 6½"

### FROM FABRIC 5, CUT:

- {G} (1) 1½" x 2½" rectangle

### FROM FABRIC 6, CUT:

- {F} (2) 1½" squares
- {G} (1) 1½" x 2½" rectangle

### FROM FABRIC 7, CUT:

- {F} (2) 1½" squares
- {G} (1) 1½" x 2½" rectangle

**YIELD** 12" finished block

# Countdown to Christmas: Winter Chalet

## STEP 1. MAKE ROOF SECTIONS

Use the Easy Corner Triangle method to create large and small roof sections. Press seams open for flatter seams.

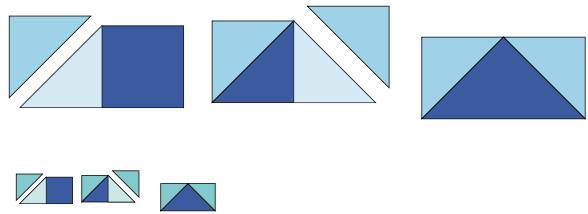

## STEP 2. MAKE UPPER WINDOWS

Join upper window sections as shown. Press and set aside.

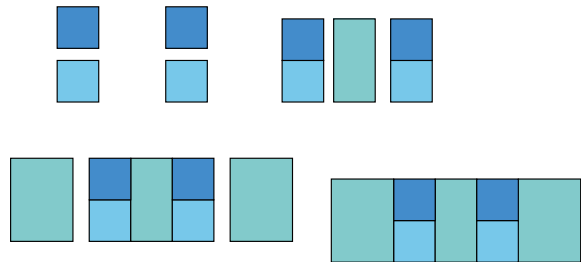

## STEP 3. MAKE LOWER WINDOWS

Join lower window pieces as shown. Press and set aside.

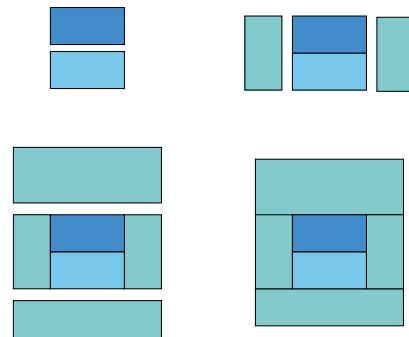

## STEP 4. ASSEMBLE BLOCK

Assemble block as shown. Trim as needed to 12½" square unfinished size.

