

## Crossroads

by Lynne Hagmeier of Kansas Troubles Quilters

The Crossroads Block combines half-square triangles, quarter-square triangles, and pieced units to create a structured yet flowing design. The intersecting shapes evoke the feeling of well-worn paths meeting at a crossroads, blending symmetry and movement.



## Cutting Instructions

Qty	9" finished block 2A	9" finished block 2B
2	4" squares (A)	4" squares (D)
8	3½" x 1½" rectangles (A)	3½" x 1½" rectangles (D)
1	5½" square, cut in half diagonally <b>twice</b> (B)	5½" square, cut in half diagonally <b>twice</b> (E)
2	4" squares (B)	4" squares (E)
2	3½" x 1½" rectangles (B)	3½" x 1½" rectangles (E)
1	5½" square, cut in half diagonally <b>twice</b> (C)	5½" square, cut in half diagonally <b>twice</b> (F)
2	3½" x 1½" rectangles (C)	3½" x 1½" rectangles (F)

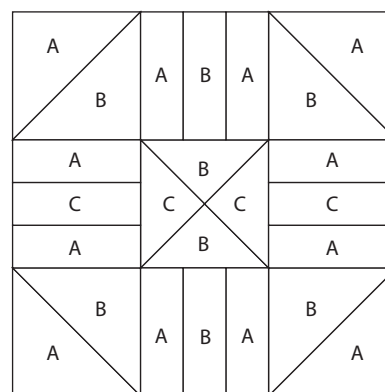

Use these blocks to plan color and fabric placement!

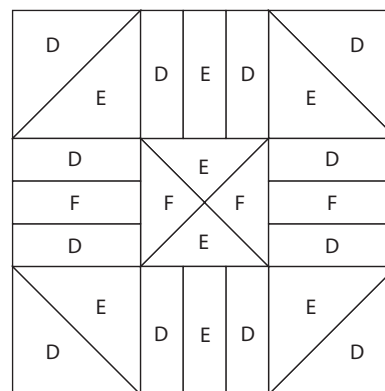

## My Swatches

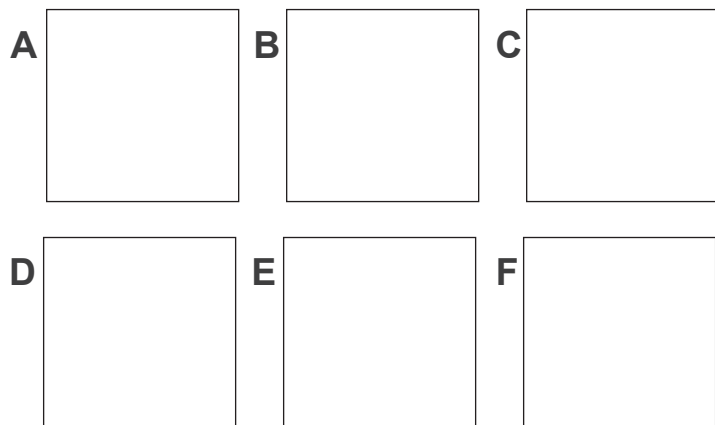

Depending on your planned layout, Fabric A and D may be the same 'Background' fabric.



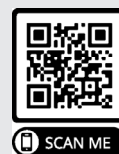

SCAN ME

## Piecing Instructions

### Step 1

On the wrong side of each 4" A/D square, draw a line from one corner to the opposing corner as shown.

Place 4" A/D and B/E squares right sides together. Stitch a scant  $\frac{1}{4}$ " on both sides of the drawn line. Cut the square apart on the line to yield two HSTs, and press the seams to the darker triangles.

Repeat to make (4) A/D-B/E HSTs. Trim HSTs to  $3\frac{1}{2}$ ".

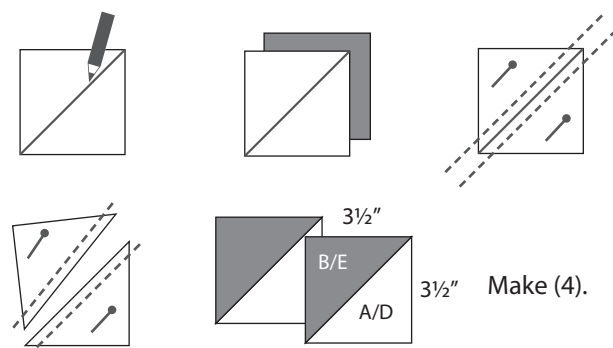

(1) A/D square + (1) B/E square =  
(2) A/D-B/E HSTs

### Step 2

Lay out (2) A/D rectangles and (1) B/E rectangle as shown.

Join to make A/D-B/E-A/D Sandwich unit, and trim to  $3\frac{1}{2}$ ".

Repeat to make (2) A/D-B/E-A/D and (2) A/D-C/F-A/D Sandwich units.

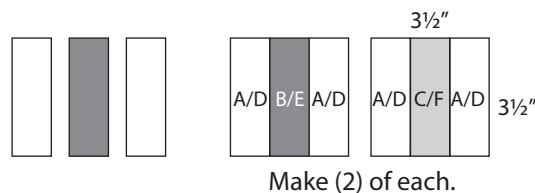

Make (2) of each.

### Step 3

Lay out (2) B/E and (2) C/F quarter triangles as shown.

Join triangles into pairs, pressing seams to B/E triangles.

Join pairs to form QST unit. Trim to  $3\frac{1}{2}$ ".

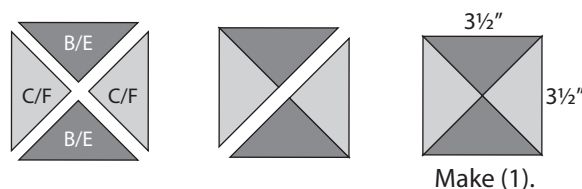

Make (1).

### Step 4

Lay out HSTs, Sandwich units, and QST as shown.

Join units to make the full block.

Trim block to  $9\frac{1}{2}$ ".

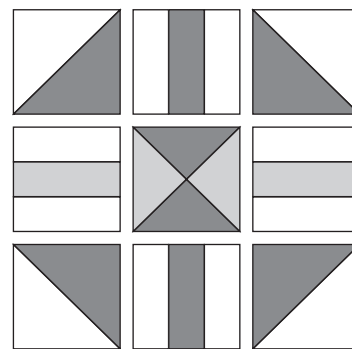

## Don't want to wait for more blocks?

See your local quilt shop to purchase the  
My Favorite Color is Still Moda pattern,  
which we are drawing from for BH6!

MY FAVORITE COLOR  
IS STILL *moda*



**Crossroads**

by Lynne Hagmeier | Kansas Troubles Quilters

**Block 2A & 2B**

*moda*  
FABRICS • SUPPLIES®



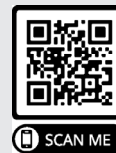

SCAN ME

## Additional Coloring Blocks

